



ELI2

Torque wrenches
Coppie di serraggio:



50 ± 4 Nm

M6 screws 10 Nm
Viti M6 10 Nm

Accessories supplied with the standard pump:
woodruff key (code 522057), M12x1.5 hexagonal
nut (code 523016), washer (code 523005). Stand-
ard ports: M6 threads depth 13 mm.

Parti accessorie a corredo della pompa standard:
linguetta a disco (codice 522057), dado M12x1.5
(codice 523016), rosetta elastica spaccata (codice
523005). Porte standard: filetti M6 profondità
utile 13 mm.

ASPIRAZIONE
INLET

MANDATA
OUTLET

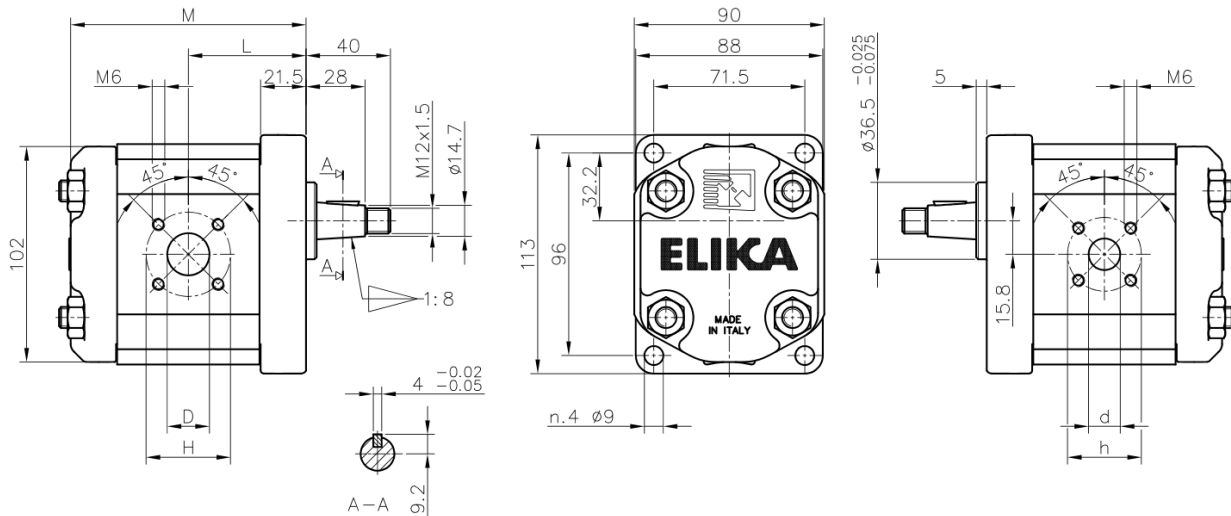

Pump Type Pompa tipo	Displ. Cilindr.	Flow at 1500 rpm Portata a 1500 rpm	Operating pressures Pressioni operative			Rotation speed Velocità di rotazione		Noise at 1500 rpm* Rumorosità a 1500 rpm		Dimensions Dimensioni					
			P1 Max cont.	P2 Max intermitt.	P3 Max peak	Minimum speed	Maximum speed	On recirc.	at P1	L	M	D	H	d	h
	[cm ³ /rev]	[l/min]	[bar]	[bar]	[bar]	[rpm]	[rpm]	[dB(A)]	[dB(A)]	[mm]	[mm]	[mm]	[mm]	[mm]	[mm]
ELI2-D-7.0	7.0	10.5	280	295	310	300	4000	47	51	48.0	96.0	15	40	15	35
ELI2-D-8.2	8.2	12.3	280	295	310	300	4000	47	52	49.0	98.0	15	40	15	35
ELI2-D-9.6	9.6	14.5	280	295	310	300	4000	48	54	50.3	100.5	15	40	15	35
ELI2-D-11.4	11.4	17.1	280	295	310	300	4000	48	55	51.8	103.5	20	40	15	35
ELI2-D-14.0	14.0	21.0	260	275	290	300	4000	49	55	54.0	108.0	20	40	15	35
ELI2-D-16.1	16.1	24.1	260	275	290	300	4000	49	56	55.8	111.5	20	40	15	35
ELI2-D-17.8	17.8	26.7	260	275	290	300	4000	49	57	57.3	114.5	20	40	15	35
ELI2-D-21.0	21.0	31.5	230	245	260	200	3500	49	57	60.0	120.0	20	40	15	35
ELI2-D-23.7	23.7	35.5	230	245	260	200	3200	50	57	62.3	124.5	20	40	15	35
ELI2-D-25.7	25.7	38.6	210	225	240	200	3000	50	57	64.0	128.0	20	40	15	35
ELI2-D-28.0	28.0	42.1	200	215	230	200	2600	50	58	66.0	132.0	20	40	15	35
ELI2-D-35.0	35.1	52.6	150	165	180	200	2200	50	58	72.0	144.0	20	40	15	35